

Wireless Mass Measurement Gauges.... the best bulk storage solution.

WHY DOES MASS MATTER?

Mass measurement starts with the weight of the total product (liquid and liquid content of the vapor) for total inventory. Loosely mass is often termed as weight. FTI then processes this accurate "mass" data to give you level, liquid net gallons, liquid gross gallons, temperature, water alarms, battery condition, and date & time. For LPG tanks addition fields include: vapor content of liquid space, total net gallons, and pressure.

DO NOT TAKE YOUR LPG TANK DOWN - NO TANK PENETRATIONS.

With FTI's new (patent pending) MMC (mass measurement chamber) you can quickly install FTI's wireless precision gauge on your tanks without electrical wiring, signal wiring, conduit runs, tank evacuation, welding couplings to tank penetrations, and extensive down time.

TECHNOLOGY PRINCIPLES

Liquids seek their own level in two tanks or chambers" - the basic principle of manifolded tanks. What is not said is that this is based on the liquid in each tank or chamber having the same density. Changes in temperature change the density of the liquid in that chamber. FTI's patented technology measures weight of the liquid in the tank and then translates that data into the other values such as level, net gallons, gross gallons, etc. We are able to tell you with great precision the weight of the product in the tank.

FTI has unsolicited customer reports of their testing of our accuracy claims. In every instance their testing results have shown greater accuracy than we claim.



US Patent 6,834,544 B2,
and others pending



13406 NE 177th Place
Woodinville,
WA 98072



Tel: 425-487-3464
888-487-6454
Fax: 425-487-6644

www.fuelingtechnologies.com



Your inventory advantage - the technology company

MASS MEASUREMENT. PRECISION AT IT'S BEST.

FTI's mass measurement inventory system exceeds 99½% accuracy. Documentation available on request. System installs in most sites without cranes or lifts. System is applicable for all fuels and most industrial liquids. System has no moving parts. System is battery powered at the tanks (wire-less), and sends data by RF signals to Master Control Unit (console).

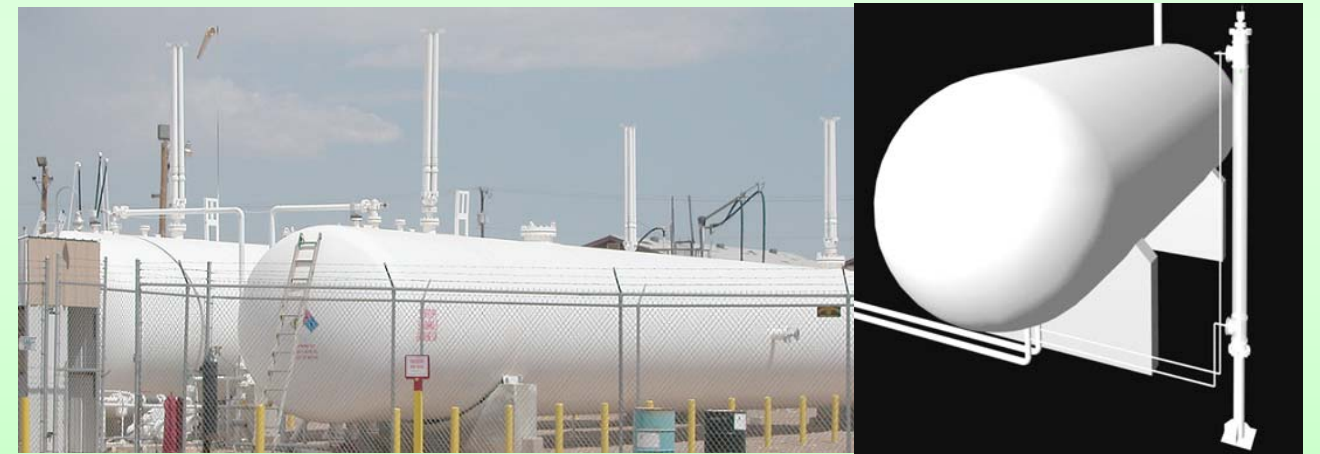

Precision mass measurement of inventory in small terminals, large terminals, and bulk plants. Our gauge is used in critical mining operations 15,000 feet into the Andes Mountains, and at water side terminals at sea level in the USA. Both meeting our accuracy claims and reliability. Both installed by TRAINED service technicians.



Installation in floating roof tanks with CAD drawings available upon request. Buoyancy tubes are sectional, coming in various lengths and coupled into lengths as required..

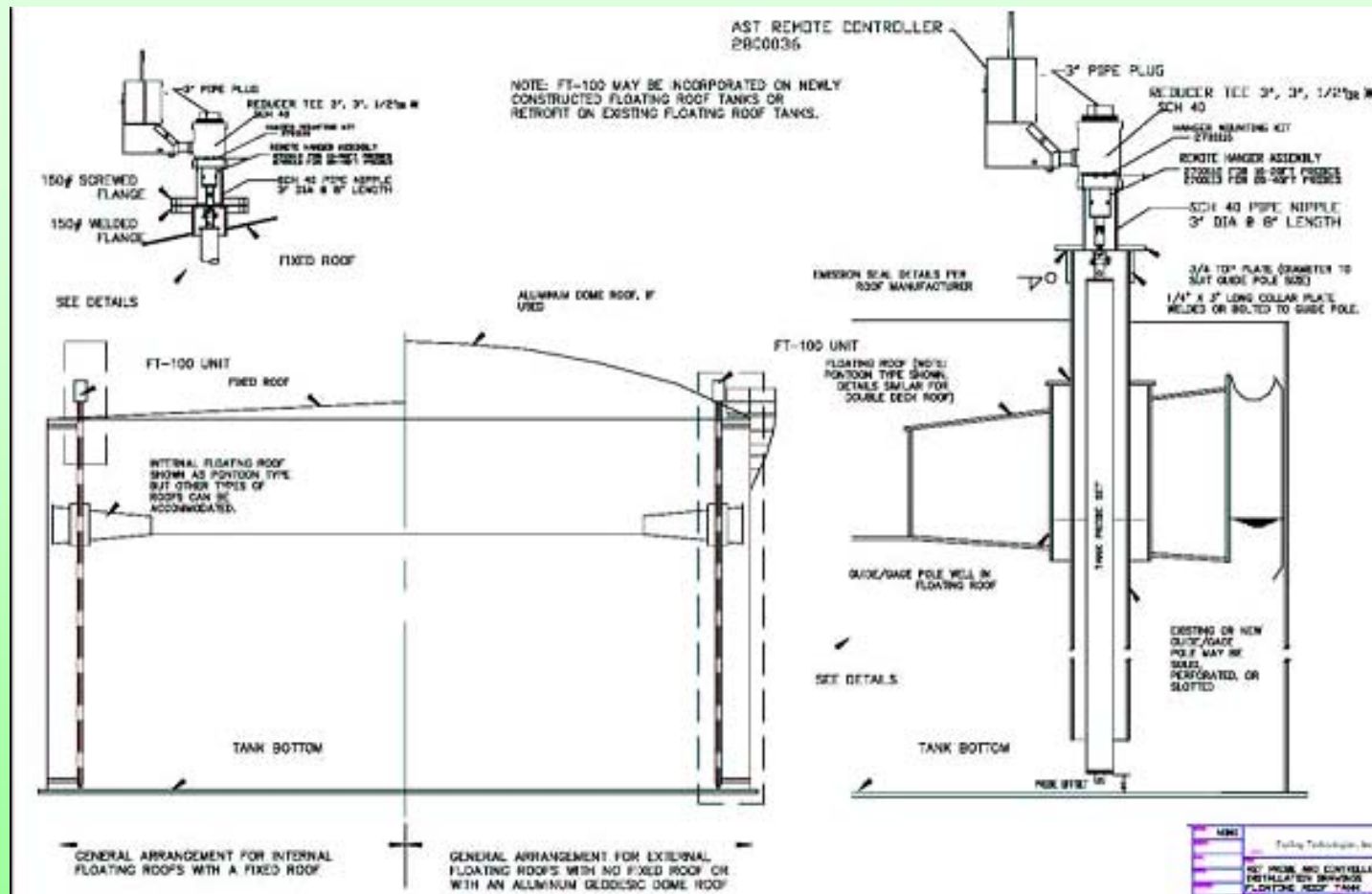

| | | Chuck's Energy Distribution Cc Gasoline, Diesel, and LPG Fuels 1st and Spruce City of Happiness State of Confusion Vertical Gasoline Bulk Storage Tank | | | | | | | | | |  | | | | | |
|--------|-------------|---|---------------|-----------|---------------|-----------------|---------------|--------|------------|------------|----------|---|----------|----------|-------------|------------|-------|
| LEVEL | WATER LEVEL | GROSS FLUID VOL | NET FLUID VOL | VAPOR VOL | NET VAPOR VOL | TOTAL GROSS VOL | TOTAL NET VOL | % FULL | TOTAL MASS | AMBNT TEMP | L/C TEMP | FLUID TEMP | VAP TEMP | BAT VOLT | ERROR FLAGS | DATE | TIME |
| 20.441 | LEVEL 2 | 970 | 955 | | | 970 | 955 | 44% | 4,205 | 73 | 72 | 69 | | 2.72 | | 08:24:1940 | 00:00 |
| 20.382 | LEVEL 2 | 966 | 953 | | | 966 | 953 | 44% | 4,197 | 73 | 72 | 68 | | 2.71 | | 09:02:1940 | 00:00 |
| 20.370 | LEVEL 2 | 965 | 952 | | | 965 | 952 | 44% | 4,193 | 72 | 71 | 68 | | 2.71 | | 09:05:1940 | 00:00 |
| 20.403 | LEVEL 2 | 967 | 954 | | | 967 | 954 | 44% | 4,201 | 72 | 71 | 68 | | 2.71 | | 08:28:1940 | 00:00 |
| 20.367 | LEVEL 2 | 965 | 952 | | | 965 | 952 | 44% | 4,189 | 72 | 71 | 68 | | 2.71 | | 09:08:1940 | 00:00 |
| 20.340 | LEVEL 2 | 963 | 951 | | | 963 | 951 | 44% | 4,184 | 71 | 70 | 67 | | 2.71 | | 09:07:1940 | 00:00 |
| 20.311 | LEVEL 2 | 962 | 950 | | | 962 | 950 | 44% | 4,184 | 71 | 70 | 67 | | 2.70 | | 09:14:1940 | 00:00 |
| 20.332 | LEVEL 2 | 963 | 951 | | | 963 | 951 | 44% | 4,184 | 70 | 69 | 67 | | 2.70 | | 09:09:1940 | 00:00 |
| 20.357 | LEVEL 2 | 964 | 952 | | | 964 | 952 | 44% | 4,189 | 70 | 69 | 67 | | 2.70 | | 09:03:1940 | 00:00 |
| 20.332 | LEVEL 2 | 963 | 951 | | | 963 | 951 | 44% | 4,184 | 69 | 69 | 67 | | 2.70 | | 09:09:1940 | 00:00 |
| 20.352 | LEVEL 2 | 964 | 952 | | | 964 | 952 | 44% | 4,189 | 69 | 69 | 67 | | 2.70 | | 09:04:1940 | 00:00 |